

RECREATION & PARKS FOR ALL

ACTIVATE ATL

 @AtlantaDPRCA

 @ATLParksandRec

 @ATLparksandrec

 activate-atl@atlantaga.gov



ATL
PARKS
& REC



RECREATION & PARKS FOR ALL

ACTIVATE ATL

Fill out our online
survey today at
activate-atl.com





Southeast Atlanta

- Bessie Branham Park
- Brownwood Park
- Coan Park
- D.H. Stanton Park
- East Lake Park
- Grant Park
- Rosel Fann
- South Bend Park
- Arthur Langford Jr. Park
- Chosewood Park
- East Lake Park
- South Bend Park
- Southside Sports Complex
- Thomasville Park
- Lang Carson Park
- And more!



Questions?



Live Stream

Comment on FB Live

Email us Directly

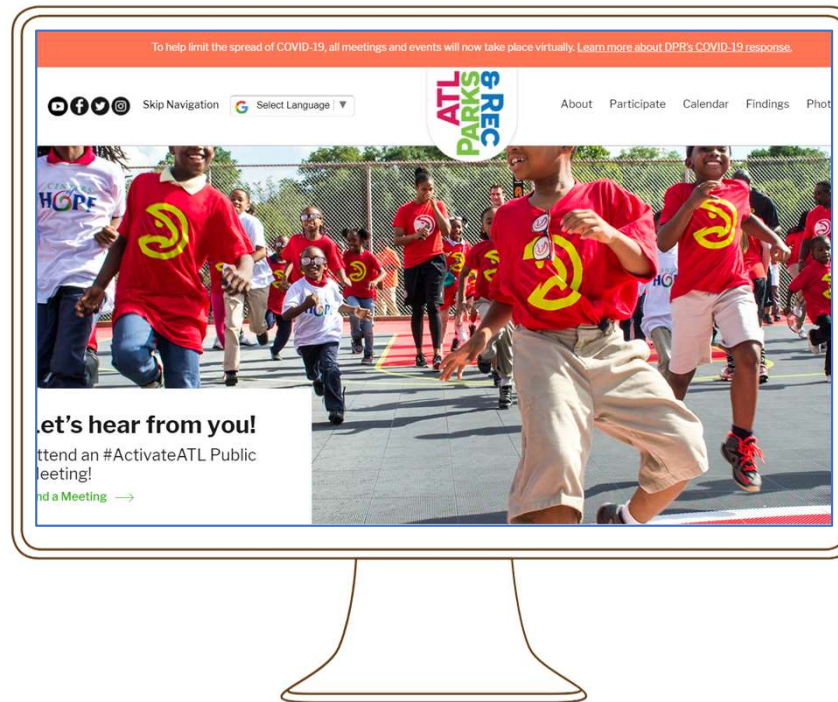

Zoom Webinar

Q&A Box for Questions

Chat Box for Messages

activate-atl@atlantaga.gov



SOUTHEAST DISTRICT

-  Facility provides water
-  Facility provides power
-  Facility provides restrooms
-  Field provides lights



PAVILIONS

- Bessie Branham Park 
- Brownwood Park  
- Coan Park  
- D. H. Stanton   
- East Lake Park   
- Grant Park   
- Rosel Fann  
- South Bend Park  

OUTDOOR COURTS

- | BASKETBALL COURTS | TENNIS COURTS |
|--------------------------|--------------------------|
| Arthur Langford Jr. Park | Arthur Langford Jr. Park |
| Bessie Branham Park | Bessie Branham Park |
| Brownwood Park | Brownwood Park |
| Chosewood Park | Chosewood Park |
| Cleveland Ave Park | Cleveland Ave. Park |
| Coan Park | Coan Park |
| East Lake | East Lake |
| Empire Park | Empire Park |
| Four Corners Park | Grant Park |
| Grant Park | Harper Park |
| Harper Park | Lang Carson Park |
| Kimpson | Phoenix II Park |
| Lang Carson Park | Rawson Washington Park |
| Phoenix II Park | Rosa L. Burney Park |
| Rawson Washington Park | South Atlanta Park |
| Rebel Valley | South Bend Park |
| South Atlanta Park | Southside Park |
| South Bend Park | Thomasville Park |
| Southside Park | Walker Park |
| Thomasville Park | |
| Windsor Street | |

FIELDS

BASEBALL FIELDS

- Arthur Langford Jr. Park
- Bessie Branham Park 
- Chosewood Park
- East Lake Park 
- South Bend Park 
- Southside Sports Complex  (Four fields)
- Thomasville Park
- Phoenix II Park

MULTIPURPOSE FIELDS

- Boulevard Crossing Park
- Coan Park 
- Grant Park
- South Bend 

FOOTBALL FIELDS

- Rosel Fann

SOCCER FIELDS

- Benteen Park
- Boulevard Crossing Park
- D. H. Stanton Park
- Southside Sports Complex 

SOFTBALL FIELDS

- Coan Park 
- D. H. Stanton Park
- Empire Park
- Harper Park
- Rawson-Washington Park

MINI PITCH

- South Bend
- South Side Sports Complex
- Thomasville

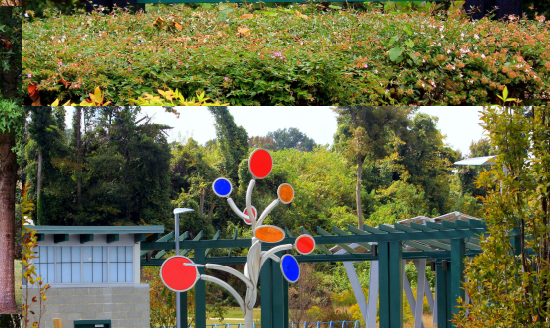
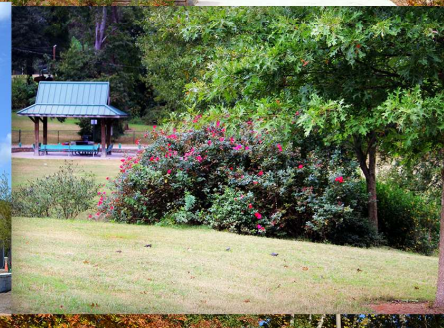

RECREATION & PARKS FOR ALL

ACTIVATE ATL

- **10-Year Comprehensive Master Plan** for City-Wide Parks & Rec
- **Park Pride** was tapped to support the public engagement effort, funded by a philanthropic donation
- Aligned with Mayor Bottom's Vision for **One Atlanta**
- **Parks and Recreation Equity** is the primary goal
- Input from the public will be used to inform **final plan recommendations and project priorities**



Population Growth | Atlanta

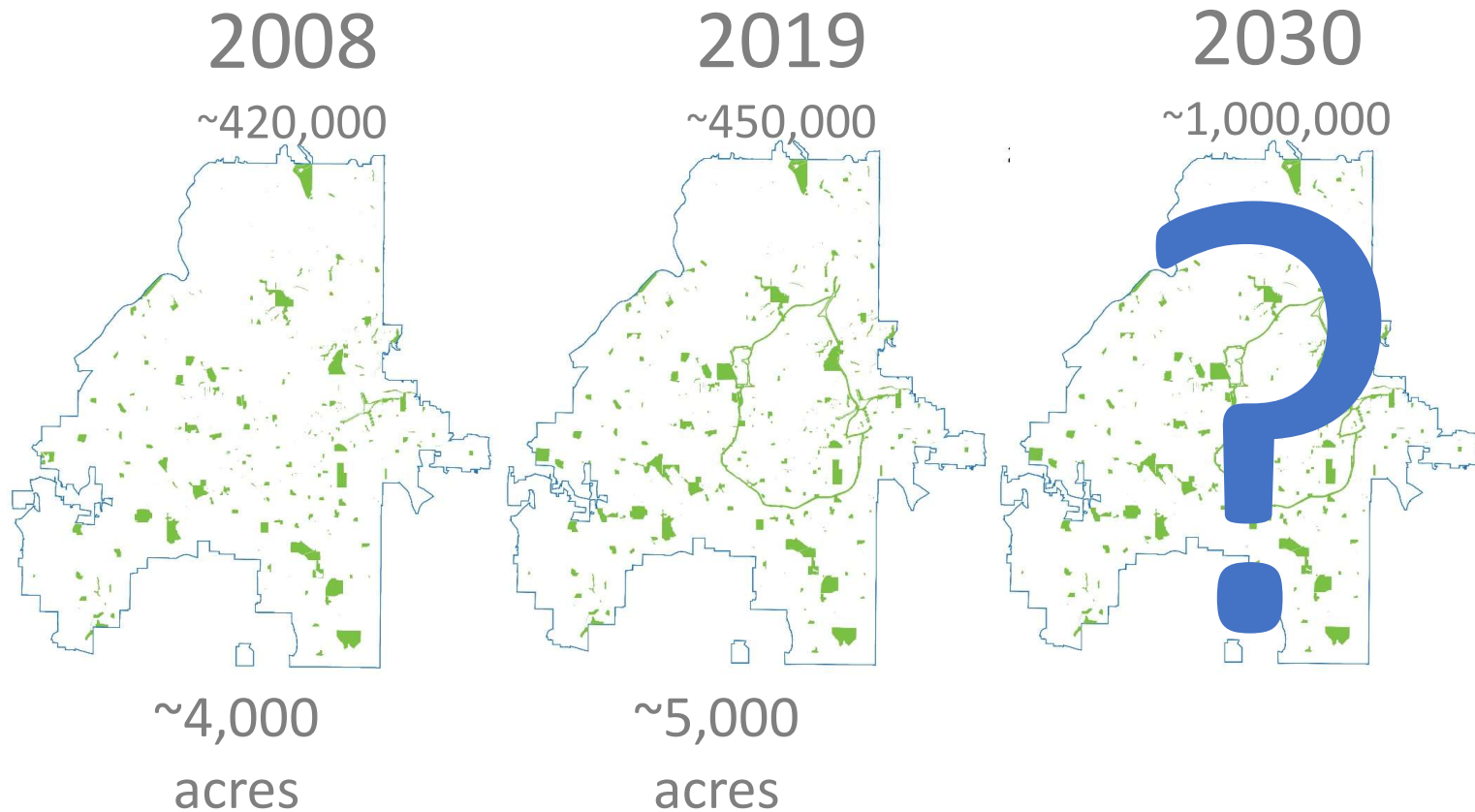

Our Approach

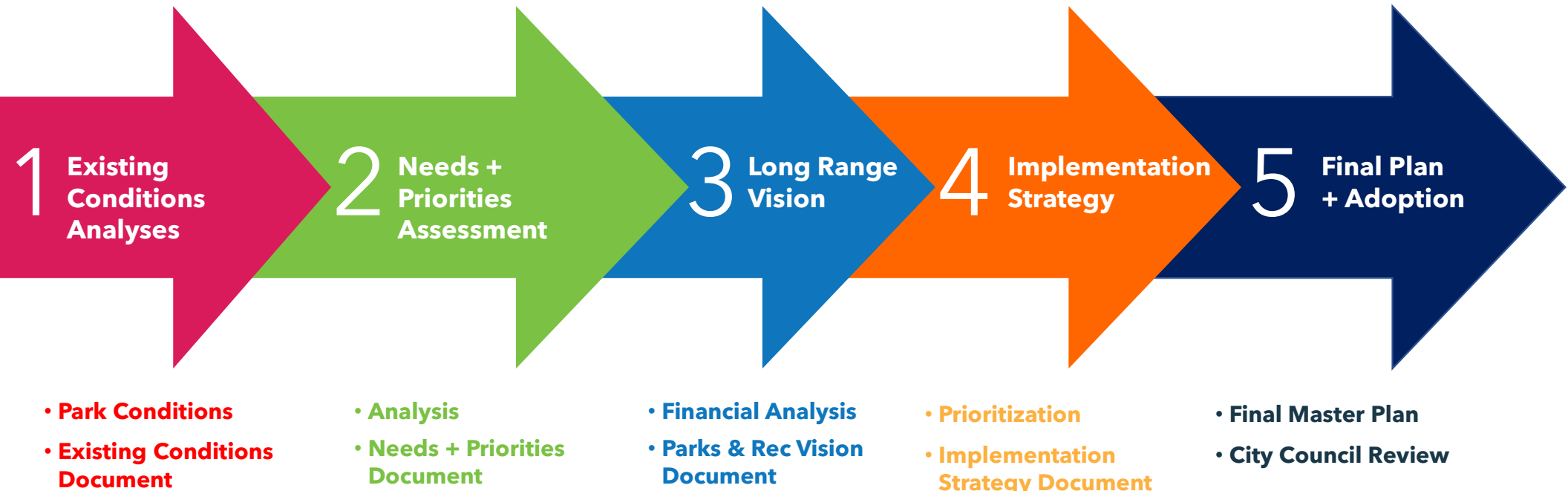

Questions?



Live Stream

Comment on FB Live

Email us Directly

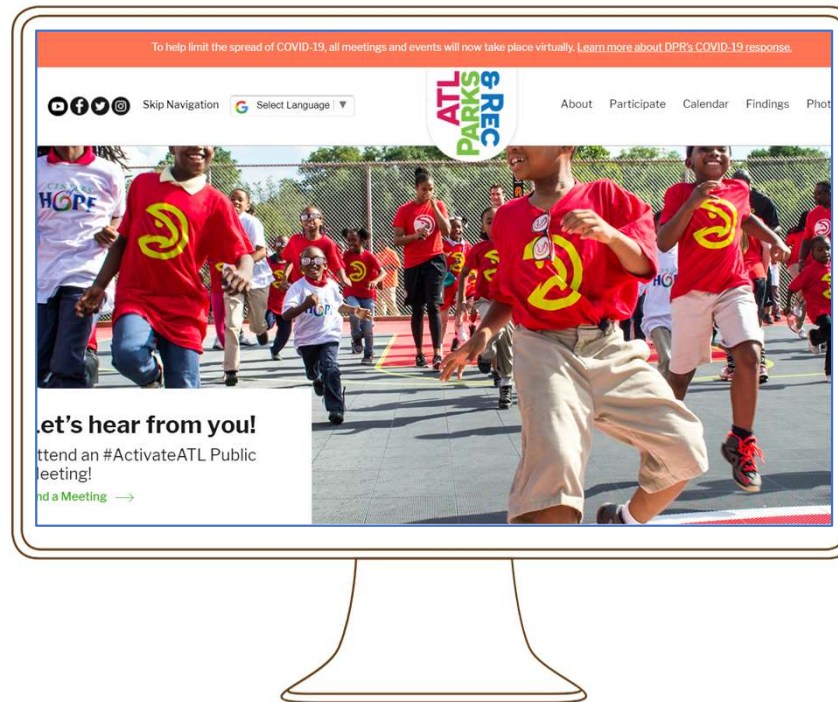

Zoom Webinar

Q&A Box for Questions

Chat Box for Messages

activate-atl@atlantaga.gov

Visit pollev.com/activateatl207

OR Text: **ActivateATL207** to: **22333**

The screenshot shows a web browser at the URL pollev.com/activateatl207. The page has a dark background and a navigation bar with links for Home, History, Registration, Support, and Profile. The main heading is "Welcome to activateatl207's presentation!". Below this is a section titled "Introduce yourself" with the instruction "Enter the screen name you would like to appear alongside your responses." A text input field contains "Activate A." and a blue "Continue" button is positioned below it. A "Skip" link is located further down. At the bottom of the page, there is a note: "Using a screen name allows the presenter and other participants to attach your screen name to your responses. You can change your screen name at any time."

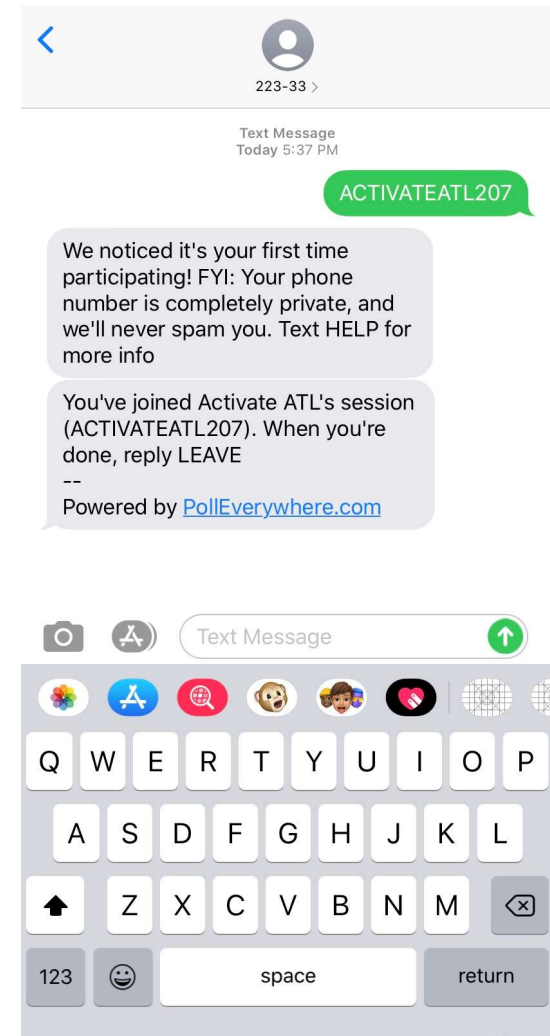

Responding with Poll Everywhere

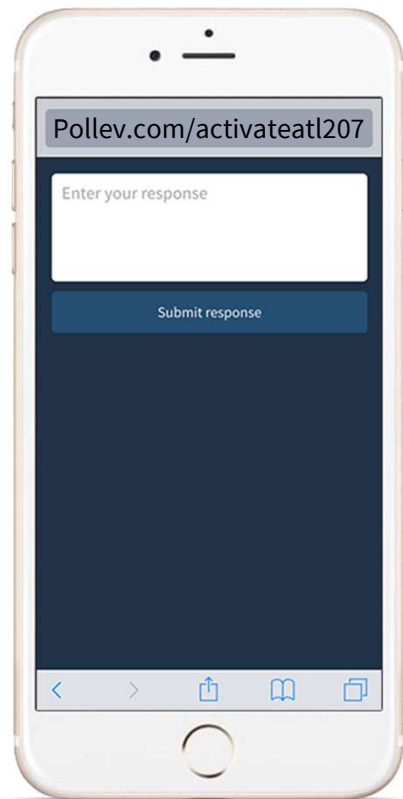

Web voting

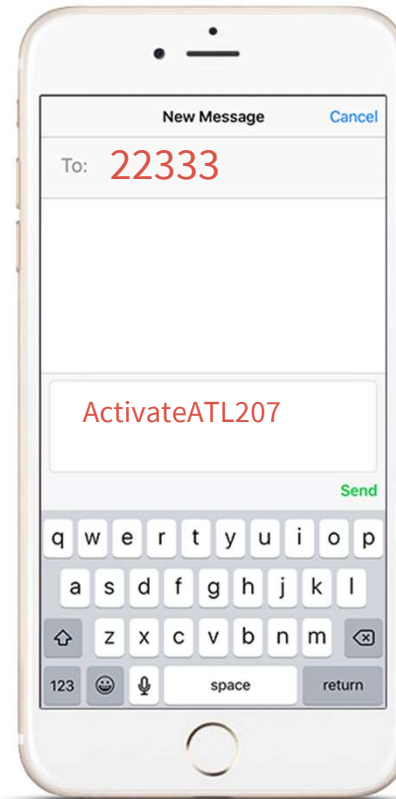

Text voting

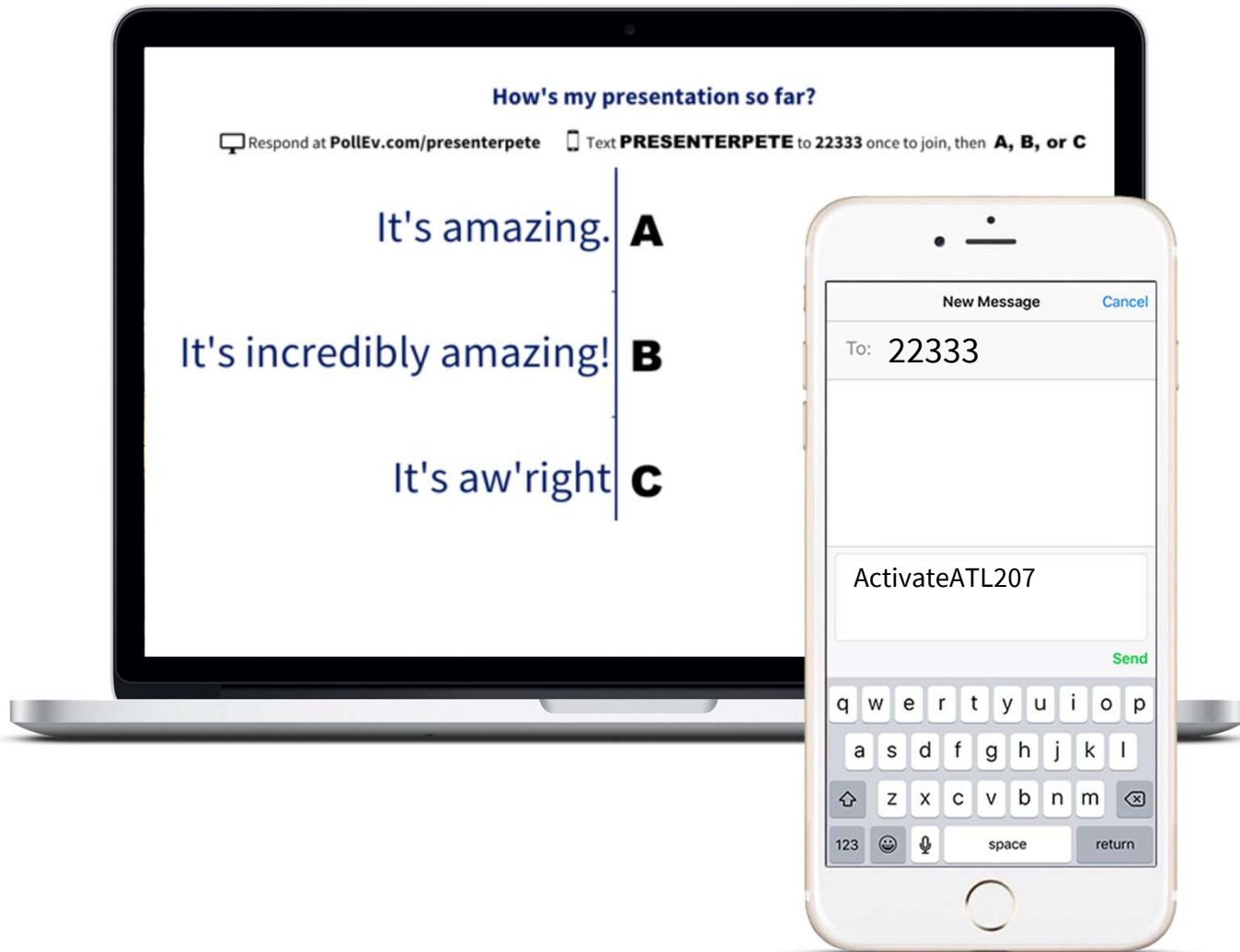

How's my presentation so far?

Respond at PollEv.com/presenterpete Text **PRESENTERPETE** to 22333 once to join, then **A, B, or C**

It's amazing. **A**

It's incredibly amazing! **B**

It's aw'right' **C**

New Message [Cancel](#)

To: 22333

ActivateATL207

[Send](#)

q w e r t y u i o p
a s d f g h j k l
z x c v b n m
123 space return

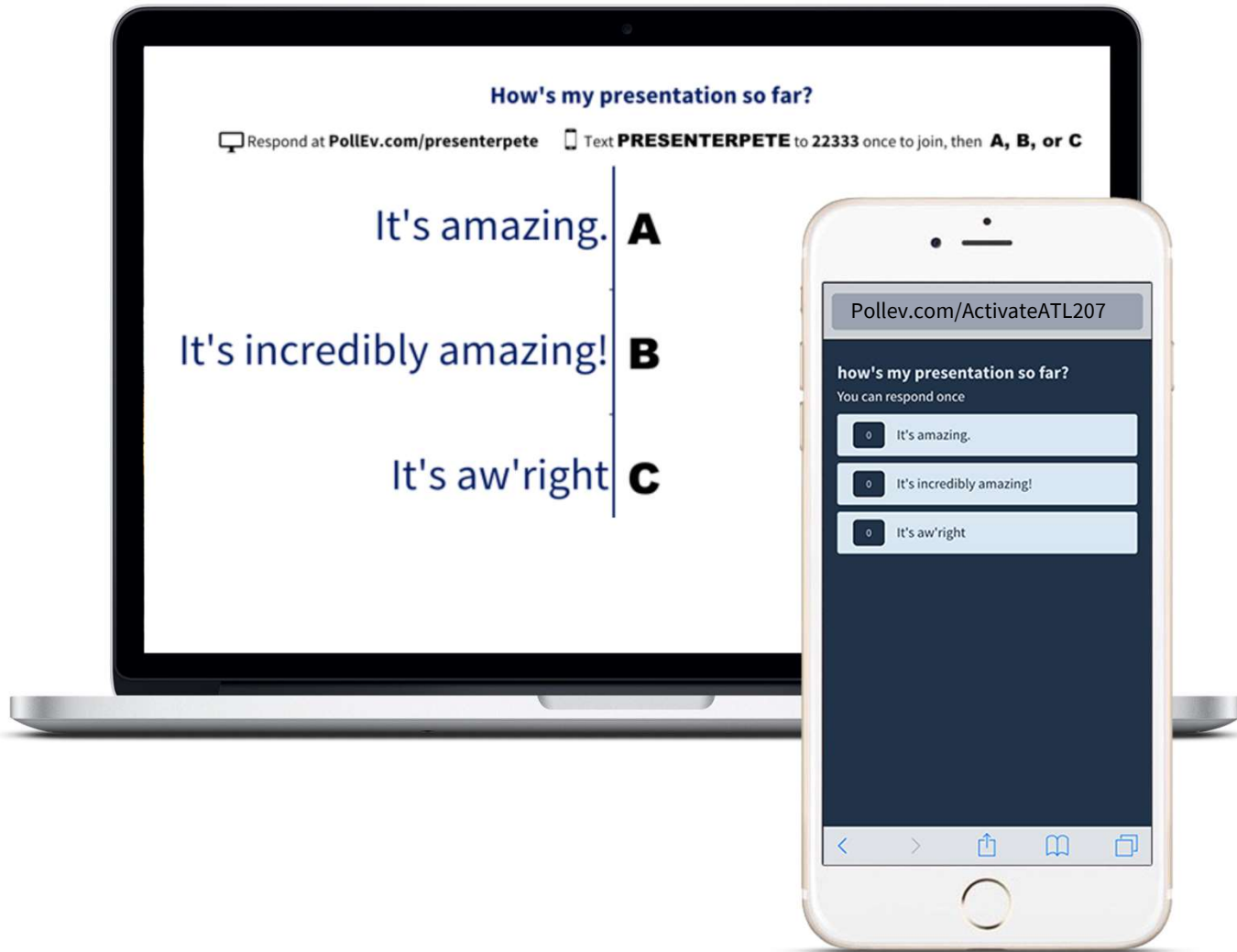

How's my presentation so far?

Respond at PollEv.com/presenterpete Text **PRESENTERPETE** to 22333 once to join, then **A, B, or C**

It's amazing. **A**

It's incredibly amazing! **B**

It's aw'right **C**

Pollev.com/ActivateATL207

how's my presentation so far?

You can respond once

It's amazing.

It's incredibly amazing!

It's aw'right



Given the recent COVID-19 crisis, how has the importance of parks, trails, open spaces, and recreation changed for you and your family?

Their importance has
increased a lot

Their importance has
increased a little bit

No change

Their importance has
decreased a little bit

Their importance has
decreased a lot

The Health Benefits of Greenspaces

ADULTS

- Stress reduction
- Improved life expectancy
- Better general mental and physical health
- Improved cognitive performance
- Improved sleep quality
- Reduction in cancer risk



CHILDREN

Improvements in:

- Attention capacity
- Concentration
- Emotional and behavioural development
- Coordination
- Balance
- Agility
- Self-confidence
- Self-discipline
- Social skills
- Weight of newborns





What types of virtual programming would you or your family be MOST likely to join?

Virtual Nature Hikes & Tours

Virtual Summer Camp

Virtual Fine Arts & Drawing Classes

Virtual Fitness Classes

Other (please send us details)

When poll is active, respond at Pollev.com/activateatl207

Text **ACTIVATEATL207** to **22333** once to join

In one word, what is your favorite thing to do at your local park and/or recreation center?

LEGEND

- PARK
- CENTERS OF HOPE
- BELTLINE
- MARTA
- INTERSTATE

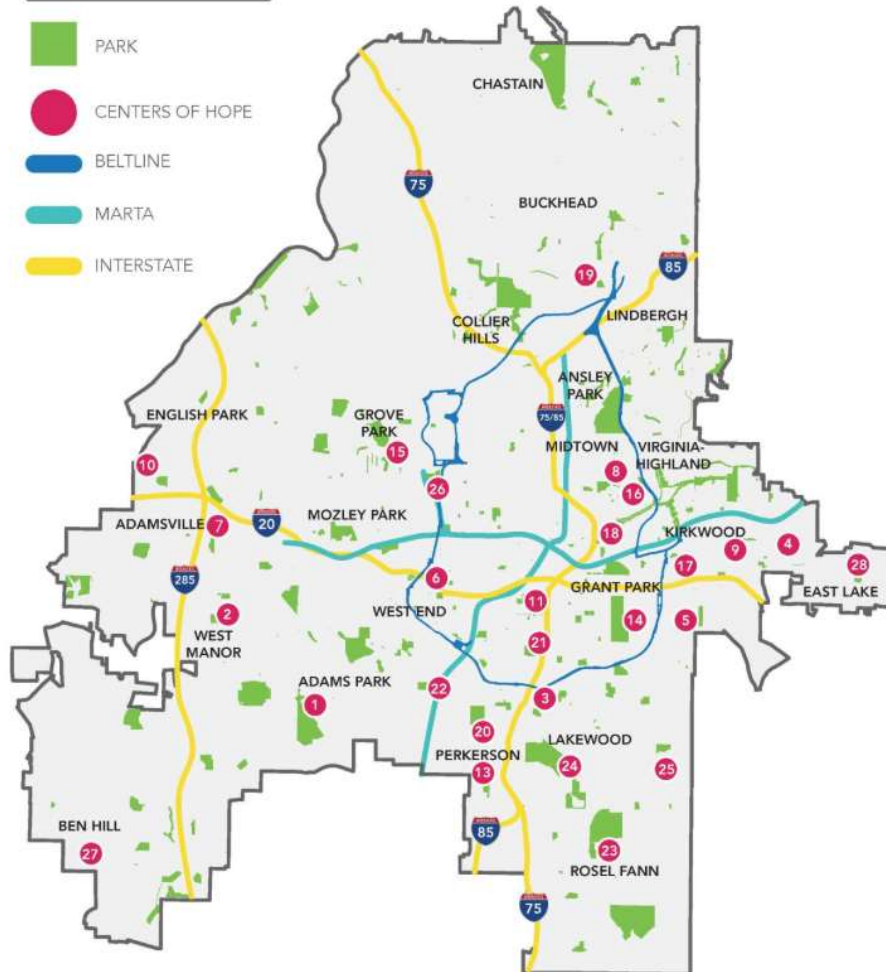

Parks & Recreation

- Golfing
- Dog Parks
- Arts & Crafts Classes
- Figure Drawing
- Hydrotherapy
- Cheer Clinic
- Soccer
- Swim Lessons
- Jewelry Making
- Ceramics
- Plein Air Painting
- Frame Making
- Bingo
- Line Dancing
- Pickleball
- Baseball
- Chorus
- Self Defense
- Zumba
- Yoga
- Cycling
- Etiquette Classes
- There's More...
- Tell Us What Else!



Questions?



Live Stream

Comment on FB Live

Email us Directly

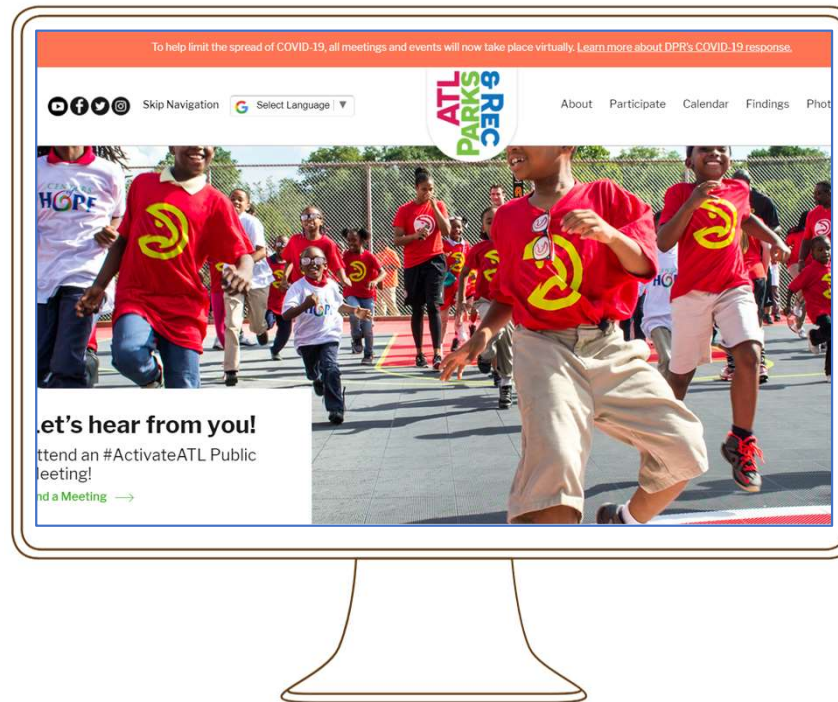

Zoom Webinar

Q&A Box for Questions

Chat Box for Messages

activate-atl@atlantaga.gov

How do you feel about your local parks and/or the recreational activities offered?

Very satisfied: Love them, I wouldn't change a thing

Satisfied: I enjoy the parks and/or activities offered

Unsure

Dissatisfied: They could be improved and/or more interesting activities could be offered

Very Dissatisfied: I would change lots of things

App Store 5:10 PM 74%

ATL PARKS & RECREATION HAPPI FEET Back

Share Your Feedback

Atlanta Parks & Recreation - Overall Comments
 233 Peachtree Street, NE, Suite 1700, Atlanta, Georgia - 30303

Share Anonymously

Yes No

Your Name

Your Email

Tell us what made you HAPPI / SAD today?

Send Updates via Email

Yes No

Share Specific Location (To Drop the Pin)

Yes No

Attach **Submit**

Attached Photo : 0 (Max. 3 upto 2 MB / Picture)
 Attached Video : 0 (Max. 1 upto 30 sec.)

App Store 5:10 PM 74%

ATL PARKS & RECREATION HAPPI FEET

Choose Location to Share your Feedback



Choose Location

About Us **Contact Us** **Help**

App Store 5:10 PM 74%

ATL PARKS & RECREATION HAPPI FEET Back

Location Sort Alphabetically

Q Search

Atlanta Parks & Recreation - Overall Comments
 233 Peachtree Street, NE, Suite 1700, Atlanta, Georgia - 30303

Kirkwood Urban Forest
 Distance 0.16 Miles
 Dixie St. SE/ Rogers St./ Bixby St. 30317, Atlanta, Georgia - 30317

 **Brownwood Park**
 Distance 0.19 Miles
 607 Brownwood Ave. SE 30316, Atlanta, Georgia - 30316

 **Coan Park**

🔗 When poll is active, respond at Pollev.com/activateatl207

📱 Text **ACTIVATEATL207** to **22333** once to join

Write IN ANY ORDER up to (3) amenities that are MOST important to you; but could be better provided: (A) Trails & Sidewalks | (B) Adventure Sports | (C) Natural Spaces | (D) Outdoor Play Spaces | (E) Indoor Performing Arts Spaces | (F) Other - Details

🖥️ When poll is active, respond at Pollev.com/activateatl207

📱 Text **ACTIVATEATL207** to **22333** once to join

Write IN ANY ORDER up to (3) amenities that are MOST important to you; but could be better provided: (A) Sports Courts | (B) Sports Fields | (C) Indoor Recreation Spaces | (D) Indoor Pool | (E) Outdoor Pool | (F) Other - Send Details

🖥️ When poll is active, respond at Pollev.com/activateatl207

📱 Text **ACTIVATEATL207** to **22333** once to join

**Write IN ANY ORDER up to (3) programs that are MOST important to you; but could be better provided: (A) Wellness & Fitness | (B) Aquatics | (C) Sports | (D) Other -
Send Details**

🖥️ When poll is active, respond at Pollev.com/activateatl207

📱 Text **ACTIVATEATL207** to **22333** once to join

Write IN ANY ORDER up to (3) programs that are MOST important to you; but could be better provided: (A) Summer Camp | (B) Visual & Performing Arts | (C) Nature Programs | (D) Community Events | (E) Other - Send Details



How would you rank the following from most to least important?

Build new parks & outdoor recreation facilities

Fix existing parks & outdoor recreation facilities

Build new indoor recreation & performance/cultural centers

Fix existing indoor recreation & performance/cultural centers

Build more walking & biking trails

Expand existing walking & biking trails

Questions?



Live Stream

Comment on FB Live

Email us Directly

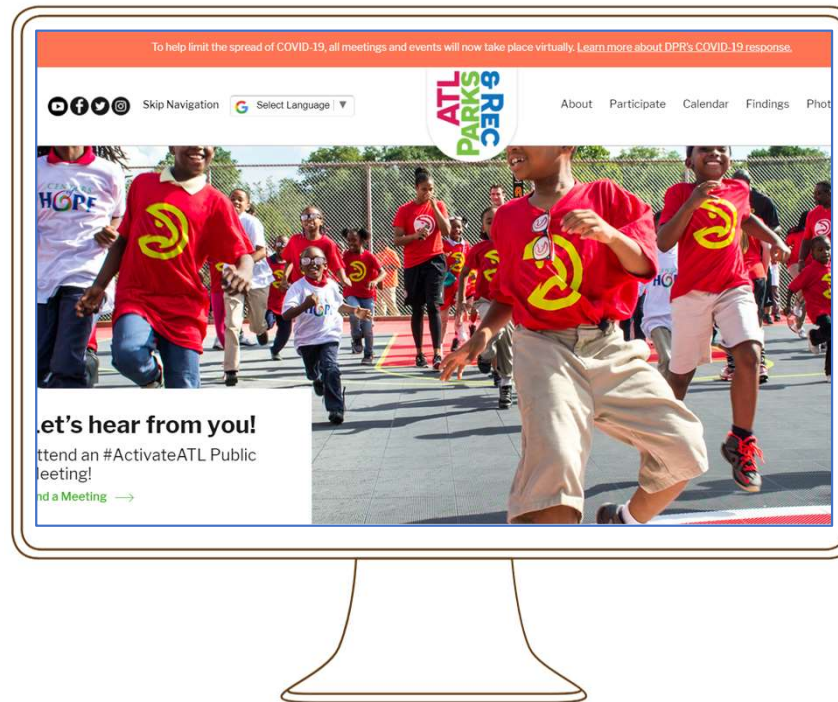

Zoom Webinar

Q&A Box for Questions

Chat Box for Messages

activate-atl@atlantaga.gov

RECREATION & PARKS FOR ALL

ACTIVATE ATL

 @AtlantaDPRCA

 @ATLParksandRec

 @ATLparksandrec

 activate-atl@atlantaga.gov



Thank You! Questions? Stay Tuned!